

FLAT STAGE SET

NO. 301 - 20' X 24'

SET INCLUDES (15) 4'x8' (122 CM x 244 CM) STAGE UNITS, TWO STAIRWAYS WITH HANDRAILS, DRAPERY CLOSURES, GUARDRAIL, AND CARTS.

Wenger®

C O R P O R A T I O N

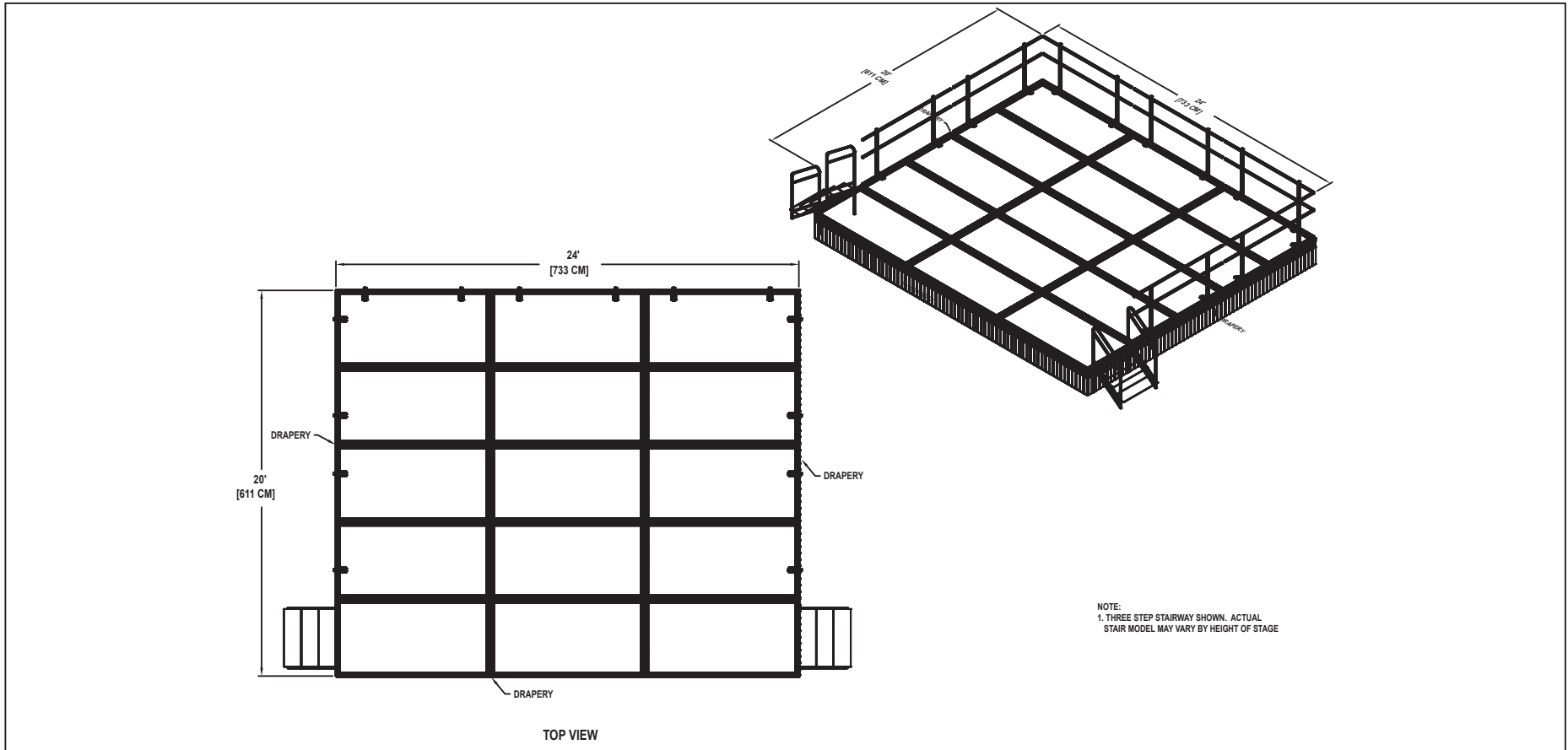

Wenger®

JRCLANCY

GEARBOSS®

Drawing 100A312_A
Sheet 7 of 18



MUSIC EDUCATION AND PERFORMING ARTS

Owatonna Office: Phone 800.4WENGER (493-6437) Worldwide +1.507.455.4100 | Parts & Service 800.887.7145 | wengercorp.com | 555 Park Drive, PO Box 448 | Owatonna | MN 55060-0448

Syracuse Office: Phone 800.836.1885 Worldwide +1.315.451.3440 | jrclancy.com | 7041 Interstate Island Road | Syracuse | NY 13209-9713

ATHLETICS Phone 800.493.6437 | gearboss.com | 555 Park Drive, PO Box 448 | Owatonna | MN 55060-0448